

AEROPIXEL REAL ESTATE SHOTLIST

Safety First!! As the Pilot/Photographer you are responsible for conducting operations legally and safely. Do not fly in a manner that compromises the legality or safety of the operation, regardless of whether or not you are able to fully complete the mission. Skip shots that compromise legality/safety.

Shot Numbers **1-27** should show each full building side, **corner to corner without being chopped off**, if at all possible. Additional shots can show all or part of a building side as per Pilot's taste.

For Ground-Based imagery, the Building should fill most of each image frame, leaving a little space on both sides.

****REMEMBER** – Shots 12-27 should include the SKY STRIP at the top of the picture!! If you have any questions at all on what that means, refer to the Pilot Center page, www.Aero-Pixel.com/pilots, and look at the example picture for Shot #21, or call us.**

Pre-Shoot QUALITY Checklist

Note this is an Abbreviated list.. please follow all quality guidelines on the Pilot Center page at www.Aero-Pixel.com/pilots

Check	Item Description
	Sky Conditions are about 25% Blue Sky or Better
	Drone Lens and DSLR Lens Clear of Fingerprints and Smudges
	Drone and DSLR both set to RAW Format
	Drone and DSLR Both set to Auto Focus, Auto White Balance
	DJI Go app Auto Exposure Lock symbol at top right of screen shows UNLOCKED

Shot Checklist

Shot Check Number	Shot Description
1	Storefront/Building Front Center – Capture Whole Building in Image if Possible
2	Right-Front – Ground-Based – Capture whole building in Image if possible
3	Right Side – Ground-Based – Capture whole building in Image if possible
4	Right-Rear – Ground-Based – Capture whole building in Image if possible
5	Rear Side – Ground-Based – Capture whole building in Image if possible
6	Left-Rear – Ground-Based – Capture whole building in Image if possible
7	Left Side – Ground-Based – Capture whole building in Image if possible
8	Left-Front – Ground-Based – Capture whole building in Image if possible
9	Pylon Sign – Ground or Aerial – Full Pylon Sign & Part of Building if possible
10	Left Street View – Looking down street with Property in Left side of Image
11	Right Street View – Looking down street with Property in Right side of Image
12	Aerial Left-Front – 150 ft Height, **Remember Sky Strip at top of image!!**
13	Aerial Left-Front – 350 ft Height, **Remember Sky Strip at top of image!!**

14	Aerial Front – 350 ft Height, **Remember Sky Strip at top of image!!**
15	Aerial Front – 150 ft Height, **Remember Sky Strip at top of image!!**
16	Aerial Right-Front – 150 ft Height, **Remember Sky Strip at top of image!!**
17	Aerial Right-Front – 350 ft Height, **Remember Sky Strip at top of image!!**
18	Aerial Right Side – 350 feet Height, **Remember Sky Strip at top of image!!**
19	Aerial Right Side – 150 Ft Height, **Remember Sky Strip at top of image!!**
20	Aerial Right-Rear – 150 ft Height, **Remember Sky Strip at top of image!!**
21	Aerial Right-Rear – 350 ft Height, **Remember Sky Strip at top of image!!**
22	Aerial Rear – 350 ft Height, **Remember Sky Strip at top of image!!**
23	Aerial Rear – 150 ft Height, **Remember Sky Strip at top of image!!**
24	Aerial Left-Rear – 150 ft Height, **Remember Sky Strip at top of image!!**
25	Aerial Left-Rear – 350 ft Height, **Remember Sky Strip at top of image!!**
26	Aerial Left Side – 350 ft Height, **Remember Sky Strip at top of image!!**
27	Aerial Left Side – 150 ft Height, **Remember Sky Strip at top of image!!**
28	Aerial Closeup Left-Front – 15 ft Height, Bldg Front Face from Close Left Angle
29	Aerial Closeup Right-Front – 15 ft Height, Bldg Front Face, Close Right Angle
30	Aerial Front-Left Offset – 15 ft Height, Front Face & Lot from a Left Offset
31	Aerial Front-Right Offset – 15 ft Height, Front Face & Lot from a Right Offset
32	Top-Down “Bird’s Eye” Shot – 350 ft Height, Sites 2 Acres or Smaller Only

******Important******

See the Shot Diagram on Next Page Below

AEROPIXEL RETAIL SHOT DIAGRAM
 Green Arrows: Ground-Based Shots
 Blue Arrows: Aerial Shots

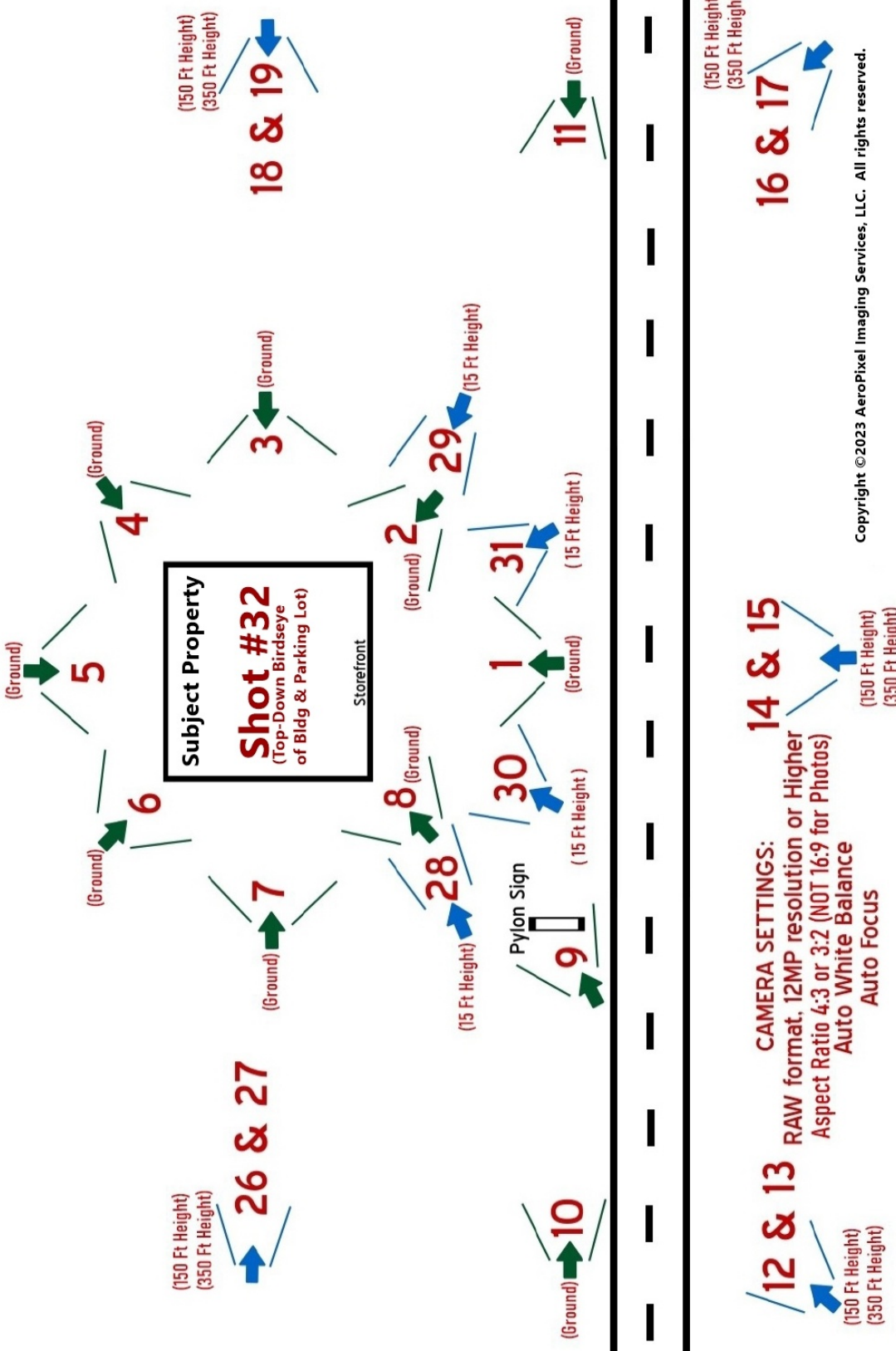

12 & 13 (150 Ft Height) (350 Ft Height)
14 & 15 (150 Ft Height) (350 Ft Height)
16 & 17 (150 Ft Height) (350 Ft Height)
18 & 19 (150 Ft Height) (350 Ft Height)
20 & 21 (150 Ft Height) (350 Ft Height)
22 & 23 (150 Ft Height) (350 Ft Height)
24 & 25 (150 Ft Height) (350 Ft Height)
26 & 27 (150 Ft Height) (350 Ft Height)
28 (15 Ft Height)
29 (15 Ft Height)
30 (15 Ft Height)
31 (15 Ft Height)

CAMERA SETTINGS:
 RAW format, 12MP resolution or Higher
 Aspect Ratio 4:3 or 3:2 (NOT 16:9 for Photos)
 Auto White Balance
 Auto Focus